



TUTORIAL  
**Watercolor  
Effect**



This is CS4 but it all the same process in any version CS & Up.

On a new document with the background white stamp two or more stained brushes with the default colors (D) in black.



**ADJUSTMENTS**

Add an adjustment

☀️ 🌲 📊 📈

▼ ▬ ⚖️ ▨ 🔍 🌐

📄 ▨ ▨ ▨ ☒

- ▶ Levels Presets
- ▶ Curves Presets
- ▶ Exposure Presets
- ▶ Hue/Saturation Presets
- ▶ Black & White Presets
- ▶ Channel Mixer Presets
- ▶ Selective Color Presets

**LAYERS** CHANNELS PATHS

Normal ▾ Opacity: 100% ▶

Lock: ☒ ✎ + 🔒 Fill: 100% ▶

👁️ Background 🔒

fx 📄 🗑️



**STEP 2**

Add a adjustment layer,at the bottom of the layers palette the b&w half circle click the Hue/Saturation option (*important*) with the (Colorize) check box on. Dial in any color you desire, here I used a magenta looking color you can use the settings to just follow along. As you can see by adding the adjustment layer a mask comes with it.

**ADJUSTMENTS**

Hue/Saturation Custom

Master

Hue: 300

Saturation: 40

Lightness: 0

Colorize

**LAYERS** CHANNELS PATHS

Normal Opacity: 100%

Lock: Fill: 100%

Hue/Saturation 1

Background

IMPORTANT

add new ADJUSTMENT layer - HUE/SATURATION

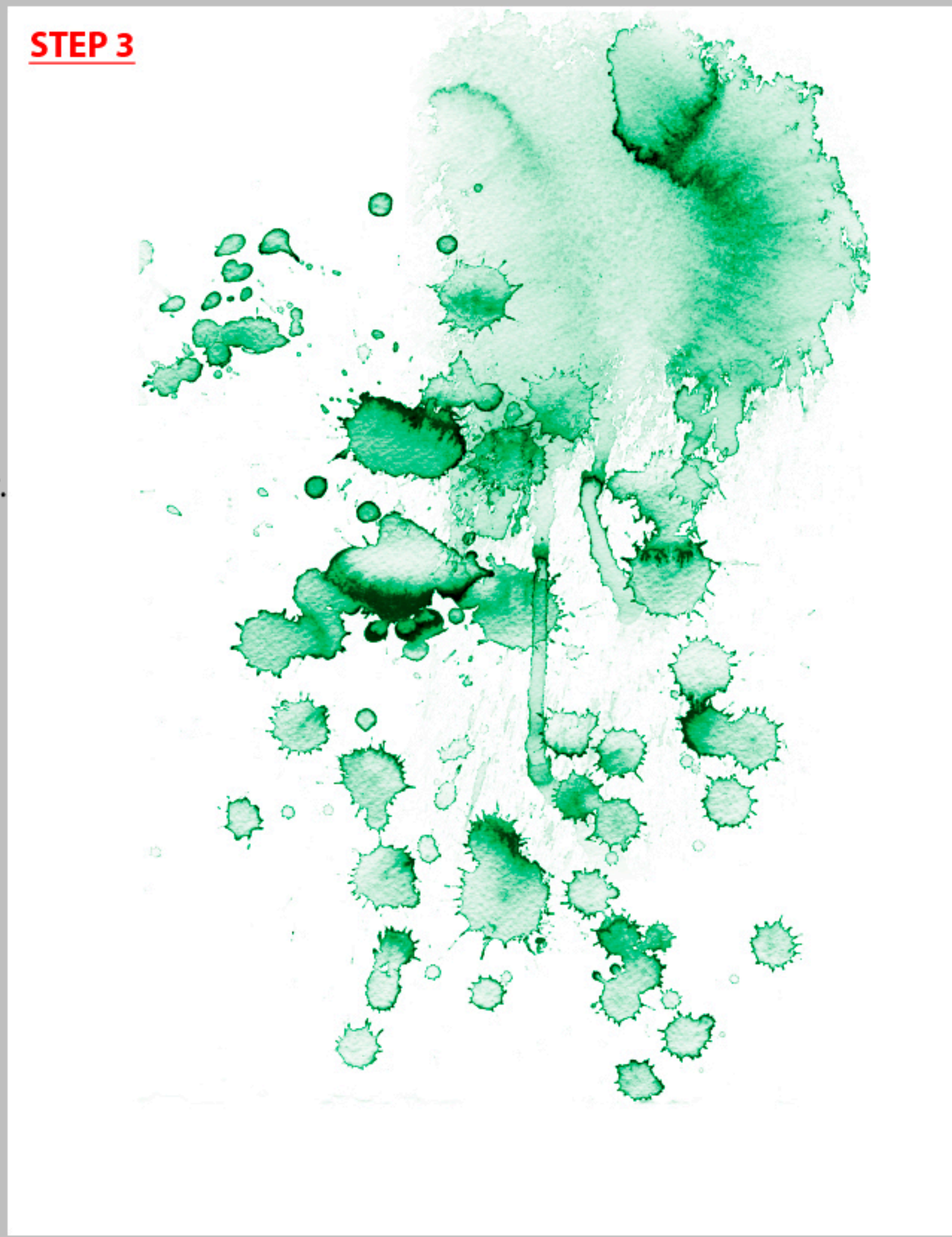

### STEP 3

Add another adjustment layer of Hue/Saturation but this time make it another color, Again making sure the colorize check box is checked. Made this a green color, make sure your layers look like mine. And the next step is where you will see why we done it this way.

**ADJUSTMENTS**

Hue/Saturation Custom

Master

Hue: 124

Saturation: 35

Lightness: 0

Colorize

**LAYERS** CHANNELS PATHS

Normal Opacity: 100%

Lock: Fill: 100%

Hue/Saturation 2

Hue/Saturation 1

Background

another adjustment layer

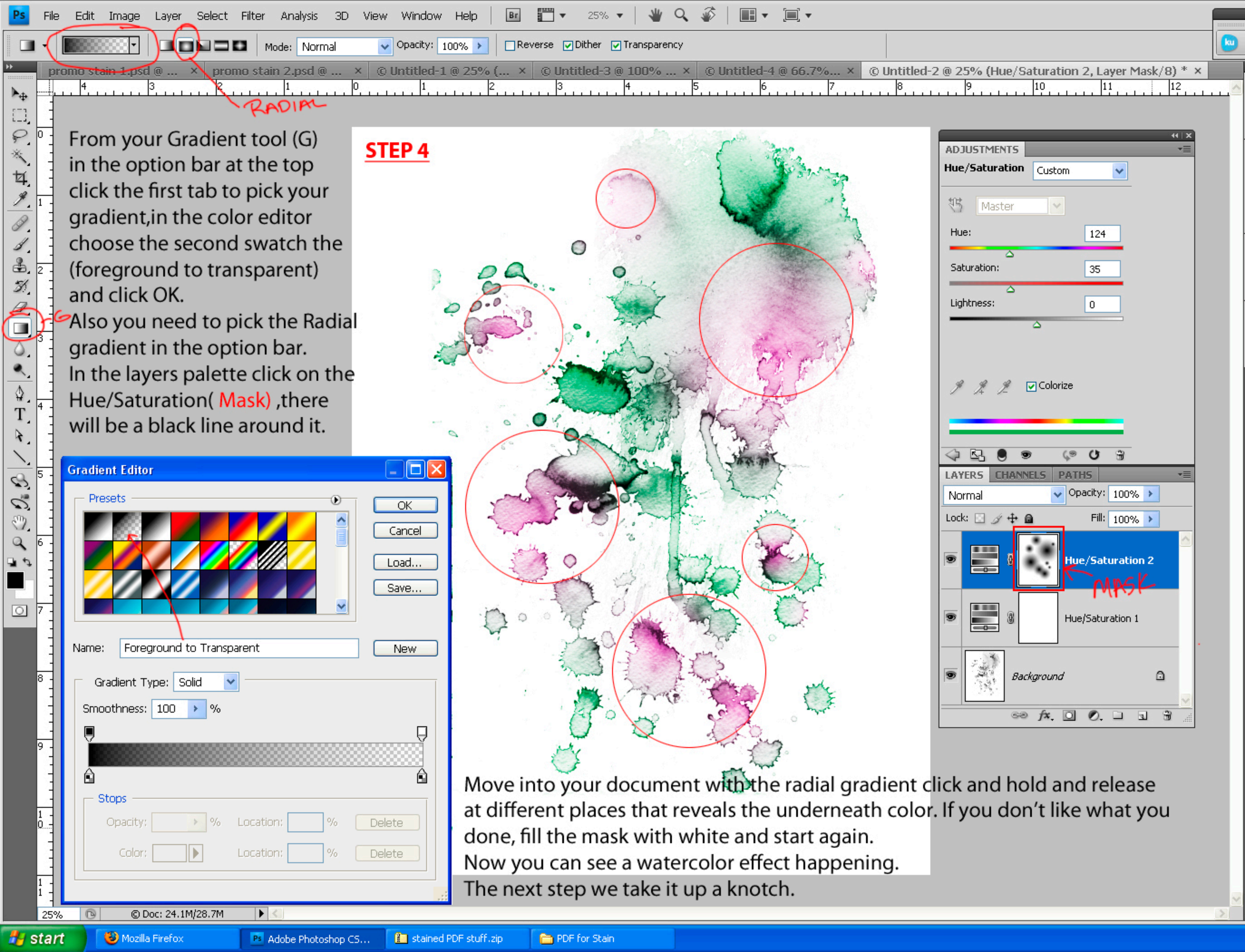

RADIAL

From your Gradient tool (G) in the option bar at the top click the first tab to pick your gradient, in the color editor choose the second swatch the (foreground to transparent) and click OK.

Also you need to pick the Radial gradient in the option bar. In the layers palette click on the Hue/Saturation (Mask), there will be a black line around it.

### STEP 4

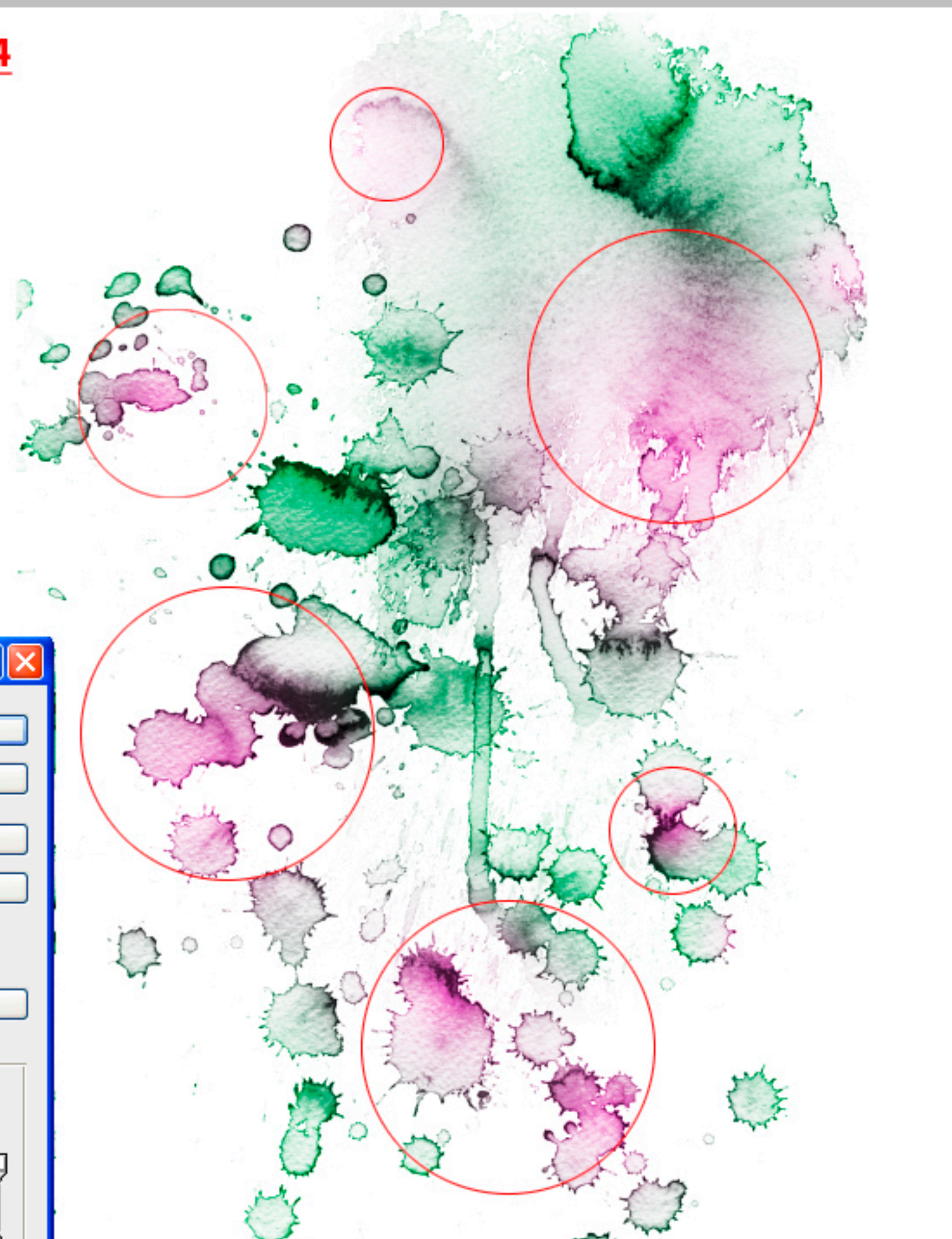

**Gradient Editor**

Presets

Name:

Gradient Type:

Smoothness:  %

Stops

Opacity: <input type="text" value="100"/> %	Location: <input type="text" value="0"/> %	Delete
Color: <input type="text" value="Black"/>	Location: <input type="text" value="100"/> %	Delete

**ADJUSTMENTS**

Hue/Saturation Custom

Hue:

Saturation:

Lightness:

Colorize

**LAYERS**

Normal Opacity: 100%

Lock:    Fill: 100%

Hue/Saturation 2 (Mask)

Hue/Saturation 1

Background

Move into your document with the radial gradient click and hold and release at different places that reveals the underneath color. If you don't like what you done, fill the mask with white and start again. Now you can see a watercolor effect happening. The next step we take it up a notch.

This next option is up to you if you were satisfied with the previous colors and happy with that its fine.

But adding another adjustment layer (Curves) this time you have overall color control with some exciting color changes more or less saturation and can be changed anytime you like while at this stage. In the adjustment curves we will use the individual color channels red green or blue (NOT the RGB overall adjustment.) From the small drop down menu in curves you open this up till you see the red channel, from the center point move it diagonally at 45 degrees to the bottom to get the color change you see here. You can make different color changes in this channel alone, but we will explore a few more while we are here.



ADJUSTMENTS

Curves Custom

Red Auto

RGB

- RGB Alt+2
- Red Alt+3
- Green Alt+4
- Blue Alt+5

Output: 61 Input: 211

LAYERS CHANNELS PATHS

Normal Opacity: 100%

Lock: Fill: 100%

Curves 1

Hue/Saturation 2

Hue/Saturation 1

Background



Still in the Red Channel I moved it up and to the left from the center point. Look how this took a dramatic change from cool colors to warm. We will do a few more but I think you are getting the idea.

**ADJUSTMENTS**

Curves Custom

Red Auto

Output: 197 Input: 61

**LAYERS** CHANNELS PATHS

Normal Opacity: 100%

Lock: Fill: 100%

- Curves 1
- Hue/Saturation 2
- Hue/Saturation 1
- Background

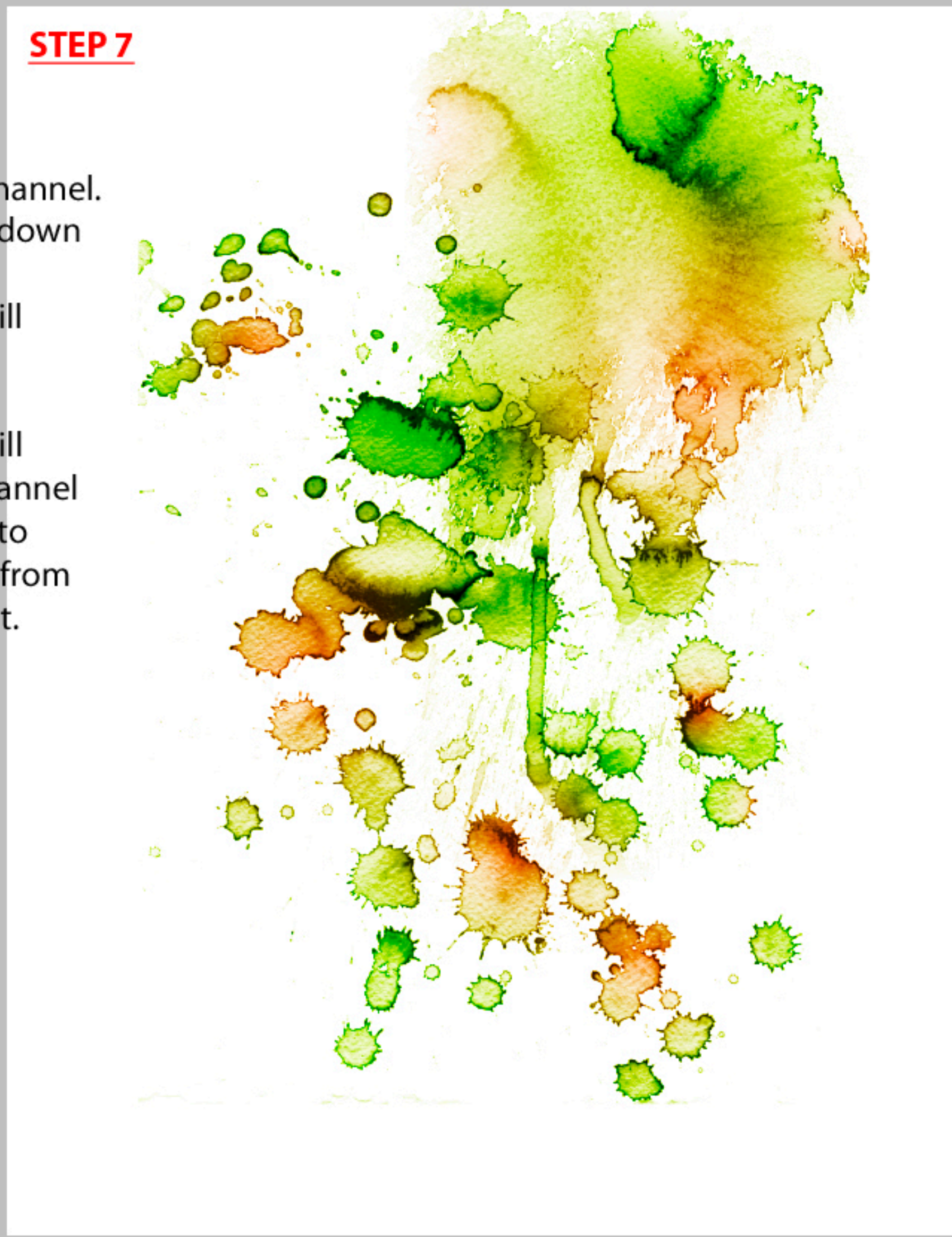

Here we went in to the Blue Channel and moved it from the center down and to the right.

Another color change while still in the same document with all the original colors in tack.

Could do this all day but we will make one more in the blue channel and final one in case we want to change the background color from white in the curves adjustment.

**ADJUSTMENTS**

Curves Custom

Blue Auto

Output: 52 Input: 207

**LAYERS CHANNELS PATHS**

Normal Opacity: 100%

Lock: Fill: 100%

- Curves 1
- Hue/Saturation 2
- Hue/Saturation 1
- Background



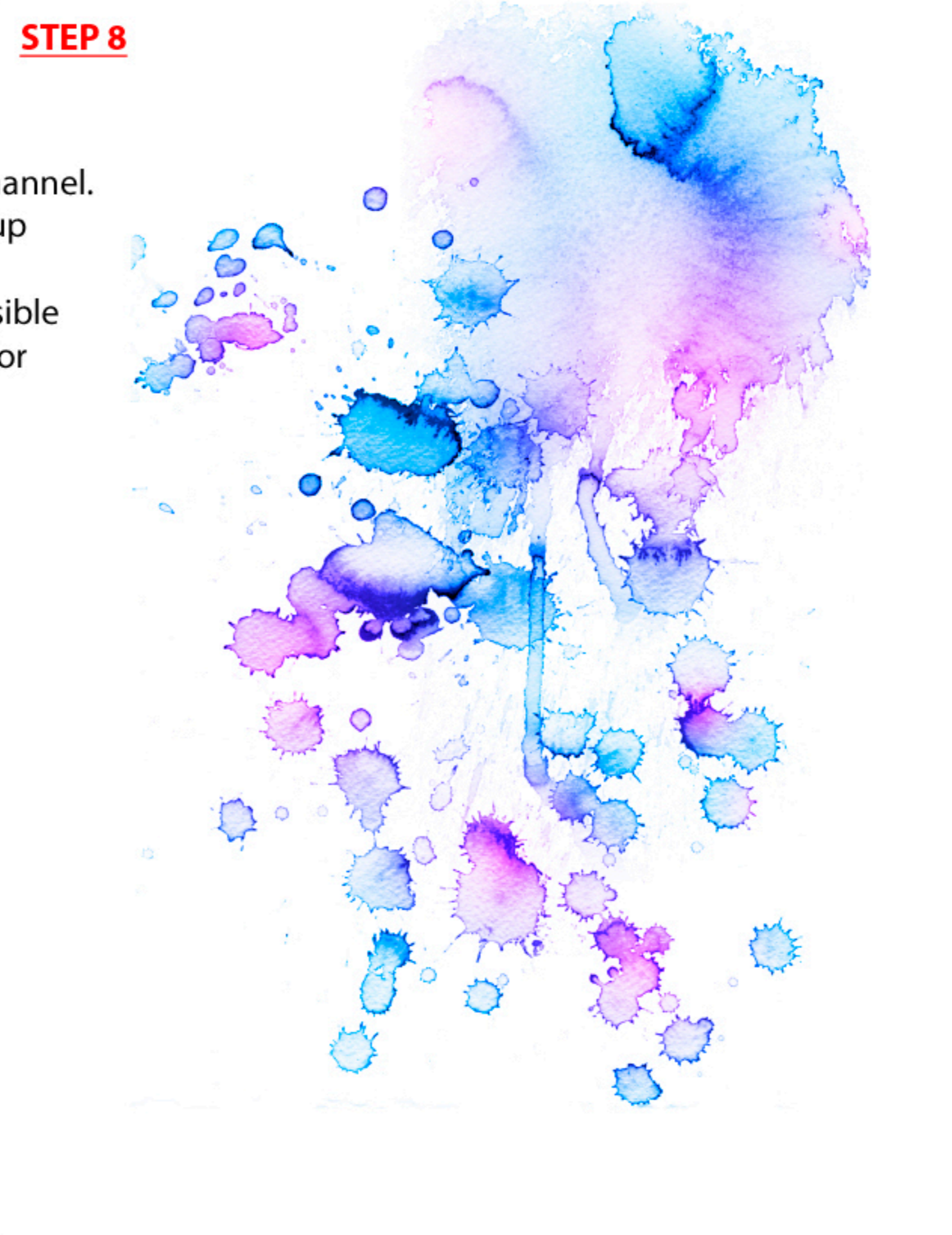

**STEP 8**

Here we went in to the Blue Channel and moved it from the center up and to the left.

Many many variations it is possible to get a color you are looking for or maybe stumble across, this could be scientific or trial and error but I like exploring new things just makes things fun.

**ADJUSTMENTS**

Curves Custom

Blue Auto

Output: 207 Input: 51

**LAYERS** CHANNELS PATHS

Normal Opacity: 100%

Lock: Fill: 100%

- Curves 1
- Hue/Saturation 2
- Hue/Saturation 1
- Background

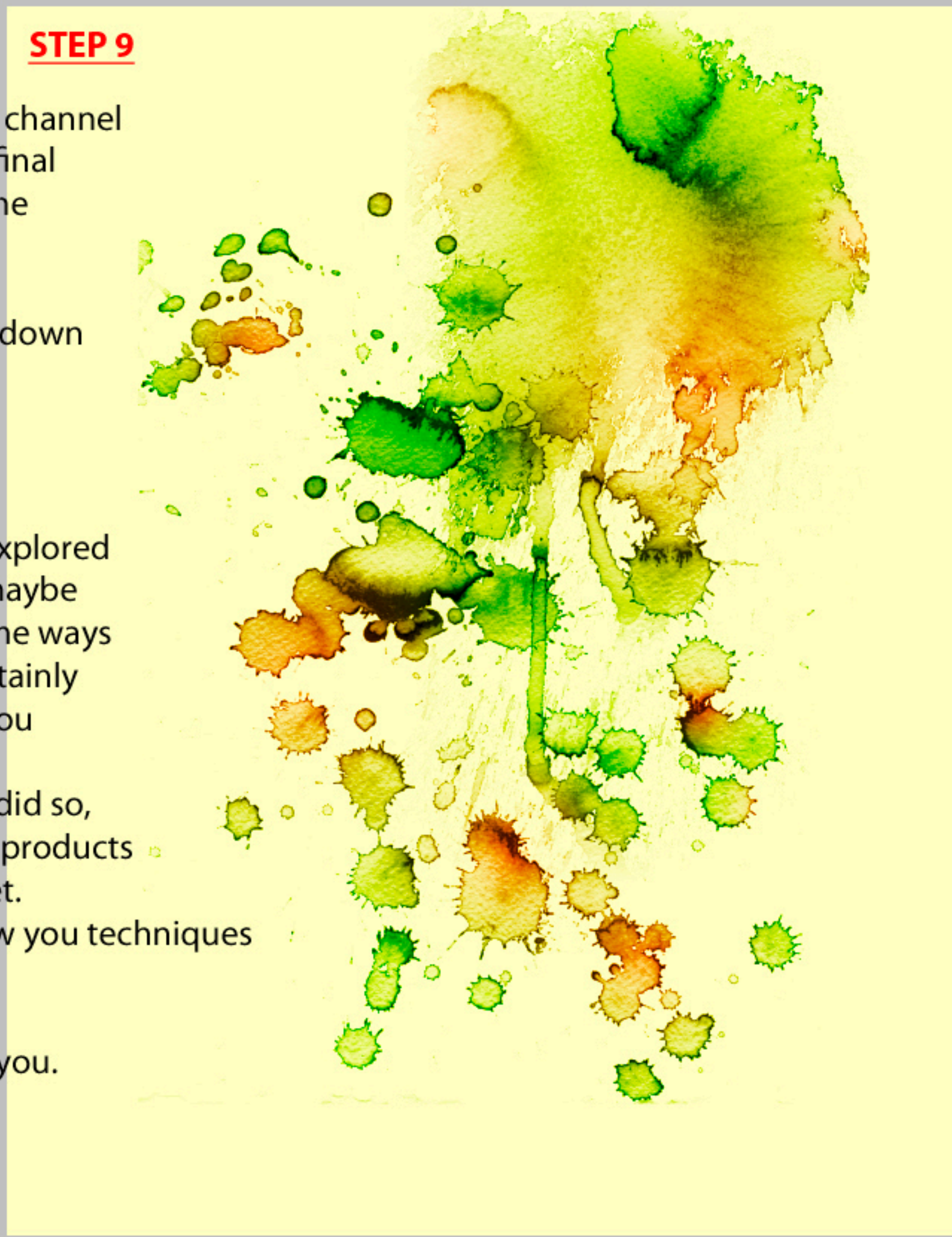

### STEP 9

Didn't ever get into the green channel but wanted to show you one final change that can be used for the background. See the blue curves top point was moved vertically straight down which gave the background and the orange and green colors a nice tinting effect. Curves adjustments is a very powerful tool and not really explored by a lot of Photoshop users, maybe this tutorial was helpful in some ways that you might find useful certainly for the Stained brushes that you purchased. I thank you everyone for that did so, my promise to you is to bring products that are the BEST in the market. And when I have time to show you techniques in using them I will. I had many buyers asking for this help and I give this to you. Thanks, Ron Deviney

ADJUSTMENTS

Curves Custom

Blue Auto

Output: 197 Input: 255

LAYERS CHANNELS PATHS

Normal Opacity: 100%

Lock: Fill: 100%

- Curves 1
- Hue/Saturation 2
- Hue/Saturation 1
- Background