

# Snapping Asian Interior Construction Kit Tips and Tricks

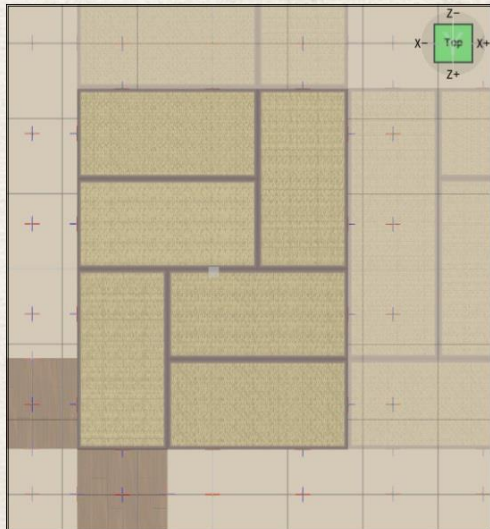

PLACE NEW LARGE FLOOR TILES ON THE RIGHT AND REAR SIDES TO AVOID OVERLAP.



WITH A LITTLE ADJUSTMENT, SCREEN TOPPERS CAN BE USED FOR WALL TOPPERS AND VICE VERSA, USE THE TARGET SCREEN TO TARGET TOPPER SCRIPTS IN THE UTILITIES FOLDER TO MAKE IT QUICKER.



START BUILDING ANYWHERE ON THE Y AXIS AND THE TARGETS WILL FOLLOW. BUT KEEP IT SQUARED THE GRID, THE DOUBLE-LENGTH PIECES CAN'T HANDLE AN ANGLE WELL.



DOORS FIT BEHIND WALLS, WALLS FIT BEHIND SCREENS, YOU CAN HAVE ALL THREE IN THE SAME PLACE WITHOUT CAUSING ARTIFACTS.